

BROOK RUN SKATE PARK



DeKalb County Parks & Recreation
PLAN OF OPERATION
June 19, 2007



GOALS

- To provide an update on the development of the Skate Park Project
- To share Management Plan
- To respond to questions regarding the plan of operation

BACKGROUND

- **1998** – Purchased land from State of Georgia
- **2001** – Contract with Dunwoody Preservation Trust creation of Brook Run Master Plan
- **2003** – Master Plan completed
- **2005** – Children's Adventure Garden completed
- **2007** – Skate Park completion

MASTER PLAN OF BROOK RUN

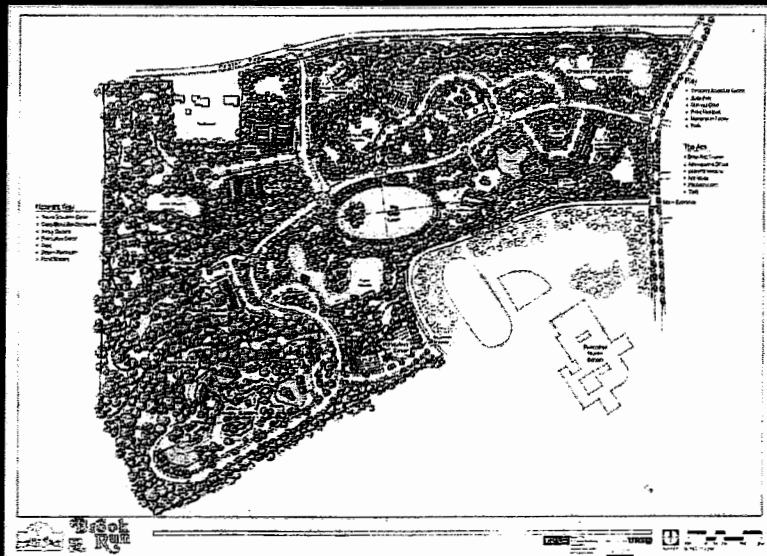



RESEARCH OF SKATEBOARD PARKS



- Looked at over fifty (50) Skate Parks
- Staff conducted extensive research on the internet
- Contacted eight (8) organizations for survey purposes to study issues such as:
 - Operating hours
 - Staffing
 - Fees & other charges
 - Waivers & Risk Management
 - Concessions
 - Rules & Regulations



RESEARCH OF SKATEBOARD PARKS



- Staff made four (4) site visits (in the Metro Area)
- Staff met with three (3) experts on the operations & marketing of skate parks
- Staff developed the operational Plan in collaboration with the following departments:
 - Finance
 - Human Resources
 - Police
 - Fire & Rescue
 - Facilities Management
 - Law Department

FINDINGS

- No standard model for operation
- Hours of operation – 7 days/week - 8 to 12 hours/day
- Year round operation
- Various Concessions: snacks, beverage, rental and sale of equipment
- Admission Fees when staffed
- Instructional programs provided



PHOTO COURTESY OF THE NATIONAL SKATEBOARDING ASSOCIATION

FINDINGS

- Waivers required for youth & adults
- Operation Budgets - \$75,000 - \$200,000
- Average Attendance – 30,000 per year
- Average Revenue - \$135,000



BROOK RUN MANAGEMENT PLAN

HOURS OF OPERATION

Spring/Summer (May-August)

Monday – Friday 10:00am – 10:30pm

Saturdays 10:00am – 10:30pm

Sundays 12noon – 10:30pm

Fall/Winter (September – April)

Monday – Friday 3:00pm – 10:00pm

Saturdays – 10:00am – 10:30pm

Sundays – 12noon – 10:30pm

CLOSED

Thanksgiving Day

Christmas Day

BMX BIKE HOURS



HOURS OF OPERATION

Tuesdays

3:00pm – 5:00pm

Thursdays

3:00pm – 5:00pm

Sundays

12noon – 2:00pm

MANAGEMENT PLAN

- **Admission Fees**
 - Daily Admission
 - Youth: \$3.00 (Res.) \$5.00 (N. Res.)
 - Adults: \$4.00 (Res.) \$6.00 (N. Res.)
 - Annual Pass
 - Youth: \$40.00 (Res.) \$60.00 (N. Res.)
 - Adults: \$50.00 (Res.) \$70.00 (N. Res.)
- **Require a waiver for each patron**
- **Staff**
 - 1 Manager
 - 2 Supervisors
 - 8 Recreation Assistants
- **Concessions**
 - Food & Beverages



MANAGEMENT PLAN

- **Maintenance**
 - Shared responsibility between Park Services and Facilities Management
- **Security**
 - Increase security by private security and DeKalb Police Dept.
- **Offer Instructional Programs**



SKATE PARK RULES AND RESPONSIBILITY CODE

- Brook Run Skate Park facility is supervised by the DeKalb County Parks and Recreation Department. Patrons assume inherent risks by using the skate park facility, including but not limited to serious personal injury and property damage. DeKalb County Government does not assume responsibility for injuries or damage to property arising from any use of this facility.

1. All patrons must complete a signed waiver in order to enter and skate in the park. All patrons under the age of 18 years of age must have the waiver signed by a parent or legal guardian. All (youth) waivers must be signed in the presence of the Skate Park staff.
2. Stay in control. Maintain proper awareness and control of speed. Do not impede or collide with others. Always skate with the flow of other skaters. Be courteous to others.
3. Wear safety gear. **Helmets are mandatory.** Elbow and knee pads are recommended.
4. Do not place, drop or throw any object in the path of a patron or on the surface of the Skate Park.
5. Alcohol, tobacco and drug use is prohibited in the Skate Park.
6. Scooters and Heelies™ are prohibited.
7. Food or beverages are allowed only in the concession area. Throw litter in trash receptacles.
8. Amplified music is prohibited (NO BOOM BOXES)
9. No pass out.
10. No metal pegs are allowed on BMX bikes
11. No weapons or animals are allowed in the park.



It's QUESTION TIME!!